

CASCADE PARK / EVERGREEN COMMUNITY LIBRARY

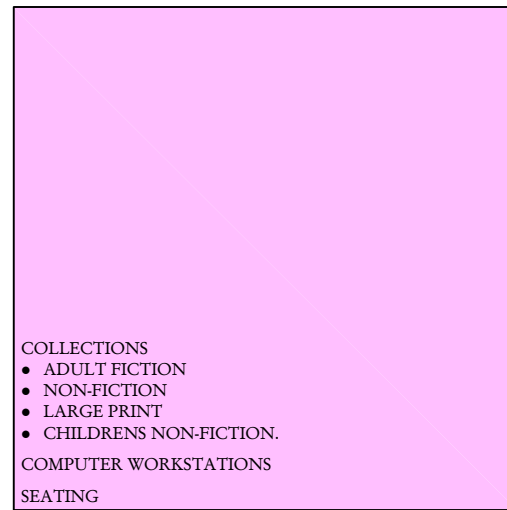

OPEN COLLECTION
 PROPOSED: 3,636 S.F.

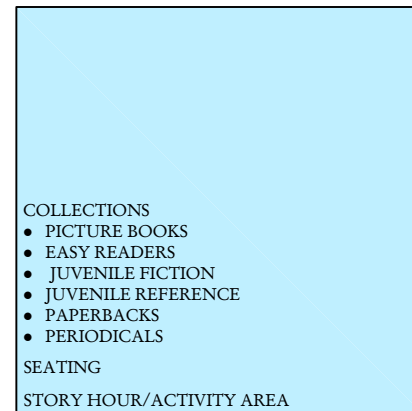

CHILDREN'S
 PROPOSED: 2,377 S.F.

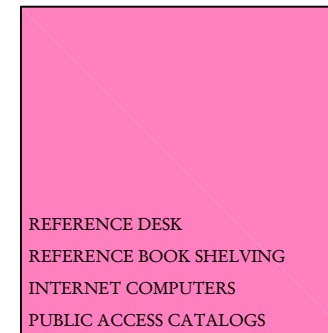

INFORMATION SERVICES
 PROPOSED: 1,536 S.F.



STAFF WORK SPACE
 PROPOSED: 1,409 S.F.

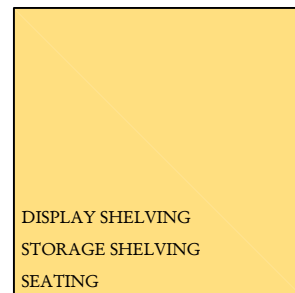

MAGAZINES / NEWSPAPERS
 PROPOSED: 1,182 S.F.

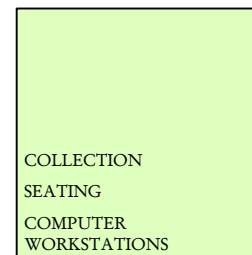

YOUNG ADULT
 PROPOSED: 895 S.F.

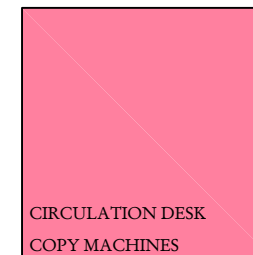

CIRCULATION SERVICES
 PROPOSED: 909 S.F.

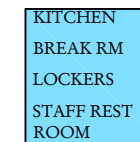

STAFF FACILITIES
 PROPOSED: 273 S.F.

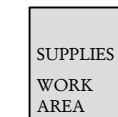

CUSTODIAL
 PROPOSED: 182 S.F.

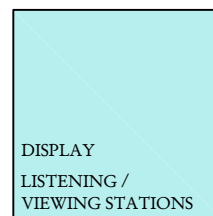

NON-PRINT COLLECTION
 PROPOSED: 636 S.F.

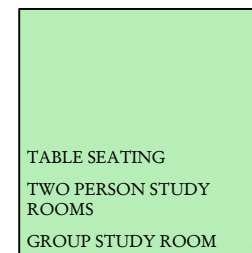

PUBLIC SEATING
 PROPOSED: 873 S.F.

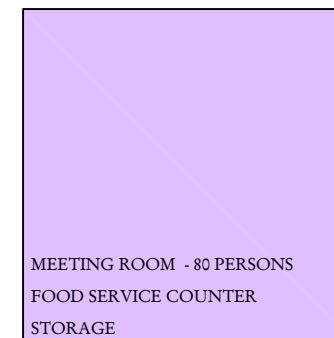

MEETING ROOM
 PROPOSED: 1,273 S.F.

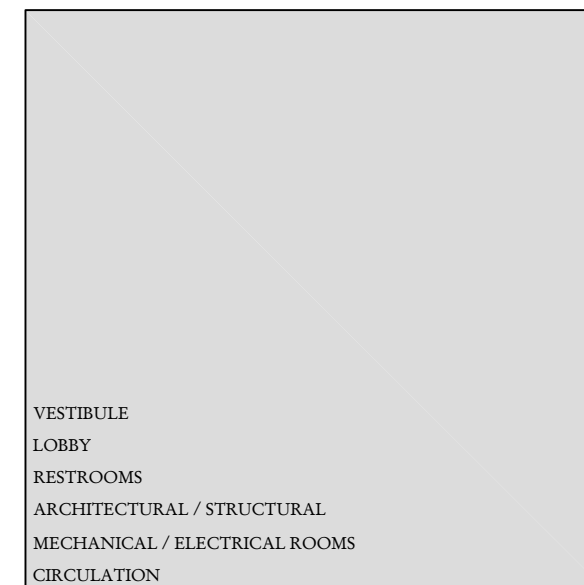

UNASSIGNED
 PROPOSED: 4,808 S.F.

EXISTING TOTAL: 2,495 S.F.

PROPOSED TOTAL: 20,000 S.F.

(BASED ON DAVID SMITH "SPACE NEEDS ASSESSMENT AND PROJECTIONS," AUGUST 2000)

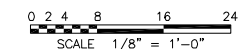

Fort Vancouver
 Regional Library

Space Allotment Diagram
 December 12, 2001

Fletcher • Farr • Ayotte • PC
 ARCHITECTURE PLANNING INTERIORS

